

Your Ref:- MLP sites

Planning Policy Team
Place Department
Nottinghamshire County Council
County Hall
West Bridgford
Nottingham
NG2 7QP

www.hanson.co.uk

Sent via email only to: planning.policy@nottscc.gov.uk

26th September 2018

Dear Sirs,

RE Nottinghamshire Minerals Local Plan – Draft Plan Consultation 27th July 2018 – 28th September 2018

In November 2017 Nottinghamshire County Council issued a Call for Sites, which invited the minerals industry, landowners and other interested parties to submit site specific information for potential new quarries or extensions to existing quarries to be considered for allocation in the new Minerals Local Plan (MLP).

The County has since published a Draft Minerals Local Plan (MLP) for consultation, which sets out the draft list of site allocations to meet expected demand over the plan period along with planning policies against which future minerals development would be assessed against.

Having reviewed the draft MLP Hanson Quarry Product Europe Limited (Hanson) comments as follows.

MP2: Sand and Gravel Provision

Question 11 – what do you think of the draft site specific sand and gravel allocations?

Remaining Permitted Reserves

Sites MP2a (Misson West) and MP2b (Newington South), noted in Policy MP2 1 (a), are sites operated by Hanson.

Permitted reserves at Misson West (MP2a) will soon be exhausted and permitted reserves at Newington South (MP2b) were exhausted in February 2018. Therefore neither of these sites, stated as to provide a combined 420,000 tonnes, will contribute existing permitted reserves towards the new MLP.

However, Policy MP2 1 (a) does not include Hanson's Newington West site as an existing permitted reserve, which was permitted in December 2015 under application reference number 1/15/01020/CDM. The site is currently operational and, as of July 2018, had remaining reserves of approximately 130,000 tonnes. At the current rate of production reserves are anticipated to be exhausted in 2019, again likely to be before the new MLP is formally adopted. A drawing identifying the site is enclosed.

Supply, Site Distribution and Proposed Allocations

Paragraph 4.18 of the draft MLP states the County estimates a shortfall of some 14.8 million tonnes of sand and gravel over the forthcoming plan period. As a result of which Policy MP2 seeks to allocate 6 extensions to existing quarries and 2 new quarries, which total some 15.46 million tonnes of reserve.

On the face of it, these proposed allocations appear to provide sufficient reserves in order to bridge the estimated total shortfall in Nottinghamshire. However, Table 3, *Contributions to the sand and gravel shortfall over the plan period*, indicates that only 3 of the extension sites and only 1 proposed new site are located within the Idle Valley.

It follows that of the total 15.46 million tonnes of additional reserve proposed for allocation, only 3.41 million tonnes is located at sites within the Idle Valley; an area suitable for viably, and sustainably, supplying sand and gravel to the north of the County as well as the Rotherham and Doncaster areas. The remaining 12.05 million tonnes is split across sites that are better suited to serve the south of the County.

This creates a clear imbalance between the north and the south of the County and their abilities to maintain an adequate supply of reserves in order to supply markets in their localities over the life of the plan, which Hanson believes should be reconsidered in detail.

Indeed, the issues of resource depletion in the Idle Valley and the north of the County, along with the associated impact on the ability to supply the Rotherham and Doncaster markets, are matters discussed at length in the County's most recent Local Aggregates Assessment (LAA), published October 2017.

The County should also recognise impacts further afield, with North Yorkshire County Councils most recent LAA (Third Review, 2017) stating, *'Pressure on NY sand and gravel resources to supply into West and South Yorkshire could also arise through any increasing constraints on supply of sand and gravel from other established supply areas such as the Idle Valley area in northern Nottinghamshire, as identified by Nottinghamshire County Council in their Local Aggregate Assessment, which concludes that resource depletion in the Idle Valley is likely to be the biggest factor potentially influencing exports to South Yorkshire. The Doncaster Local Aggregate Assessment states that South Yorkshire has an adequate supply of sand and gravel in the short term, but further reserves will need to be made available from alternative sources to ensure a steady and adequate supply. It also notes that production of sand and gravel in Nottinghamshire is moving southward away from the Idle Valley, which could impact on supply later on in the plan period. A joint position statement relating to aggregates supply into Doncaster and Rotherham from Nottinghamshire and Derbyshire has been completed by the relevant authorities to help safeguard the aggregates supply position.'*

Duty to Co-Operate

As mentioned above, in November 2016 a joint minerals position statement was agreed between Nottinghamshire County Council, Rotherham MBC and Doncaster MBC. Amongst other things, Issue 2 of the Statement, which concerns the continued provision of sand and gravel to Rotherham MBC and Doncaster MBC, states *'Historically, a significant amount of sand and gravel has been exported to Rotherham Metropolitan Borough Council and Doncaster Metropolitan Borough Council from the Idle Valley in the north of Nottinghamshire. This demand is expected to continue as the Rotherham and Doncaster joint LAA identifies a current lack of permitted sand and gravel quarries in the area along with a significant shortfall expected over the plan period'*.

The statement continues by noting, *'As part of the wider discussions between the three authorities a joint aggregate minerals position statement has been prepared. This sets out an agreed approach that*

Nottinghamshire would continue to contribute to expected demand from the Rotherham and Doncaster areas in the short term’.

The County will no doubt be aware that Doncaster MBC is currently preparing a new Local Plan for the period up to 2032 and that consultation is underway on its various visions, objectives, policies and proposals, which will include policies in respect of minerals. The County is referred to Doncaster MBC’s document titled *Local Plan Evidence Base, Assessing Mineral Sites Representations, Version: Consultation Draft May 2018*, which states: ‘*Evidence within previous LAAs indicates that it may be difficult for the council to maintain a supply of sand and gravel to meet our apportionment up to the end of the plan period..... Previous monitoring reports and aggregate assessments identify that sharp sand and gravel essential for concreting products is a declining resource in our area and will become increasingly difficult to find in the future. The Local Aggregates Assessment (LAA) identifies minerals flow between authorities and counties and quarries in North Nottinghamshire will in the short term provide sand and gravel to support development in Doncaster. 30% of the sand and gravel extracted in Nottinghamshire is exported to the Yorkshire and Humber region, there is however no additional detail as to how much is consumed in the Doncaster area. The Aggregate Minerals Survey collects monitoring figures as part of a four yearly survey; this survey confirms that in 2009 84% of the sand and gravel landbank was made up of soft sand, which has a small but on-going demand. Paragraph 3.9 of the 2014 Annual Monitoring Report also confirms that that the reserves of sand and gravel in South Yorkshire are almost exclusively made up of soft sand deposits. This has resulted in fewer larger mineral companies coming forward with site representations or extensions to existing quarries.*’

This further emphasises the importance of Nottinghamshire’s sand and gravel reserves to neighbouring authorities and the need for the County to re-consider the geographical distribution of site allocations in the new MLP; to ensure that the ability to viably supply sand and gravel to the north of the county and neighbouring areas is maintained over the life of the plan.

Barnby Moor

It is clear that the County has sought to favour the allocation of a fewer number of larger potential sites and site extensions in order to maintain supply over the plan period. Whilst the merits of this approach are recognised in the longer term, Hanson considers there is still a need to maintain the immediate supply of reserves during the early years of plan.

The County’s October 2017 LAA indicates that Hanson’s Newington Quarry currently contributes the equivalent of 16% of the total sand and gravel sales produced by Nottinghamshire sand and gravel quarries. Importantly, the site predominantly serves markets in the north of the County as well as Rotherham and Doncaster.

As previously mentioned, Newington South and Misson West will not contribute to the County’s existing permitted reserves during the plan period. Newington West, which is not identified as an existing site in policy MP2, is anticipated to be exhausted prior to adoption of the new plan, so will not contribute either.

As such the contribution Newington currently makes, particularly in providing a much needed supply for the north of the County and neighbouring areas, will be lost if a replacement site does not come online in the early stages of the new plan.

Hanson maintains its view that Barnby Moor represents a viable and deliverable site within the Idle Valley resource block, which can help to maintain the supply of much needed concreting aggregates to the Nottinghamshire and South Yorkshire and Doncaster markets. As described, the latter areas depend heavily on imports to meet their construction needs. Given the positive contribution that

Barnby Moor would make as a replacement for Newington, Hanson considers this should be reflected by an allocation of the site.

Following Hanson's January 2018 Call for Sites submission, the Council expressed concern over the status of the landownership at Barnby Moor, which is referenced in the Analysis within Table 9, Summary of Key Issues, of the County's *Draft site selection methodology and assessment July 2018*. The landownership has since been resolved and, as a result, Hanson subsequently wishes to submit a revised proposal for the County to reconsider allocating the site. Full details and plans are enclosed.

Yours faithfully,



Land and Planning Manager
Land and Mineral Resources Department

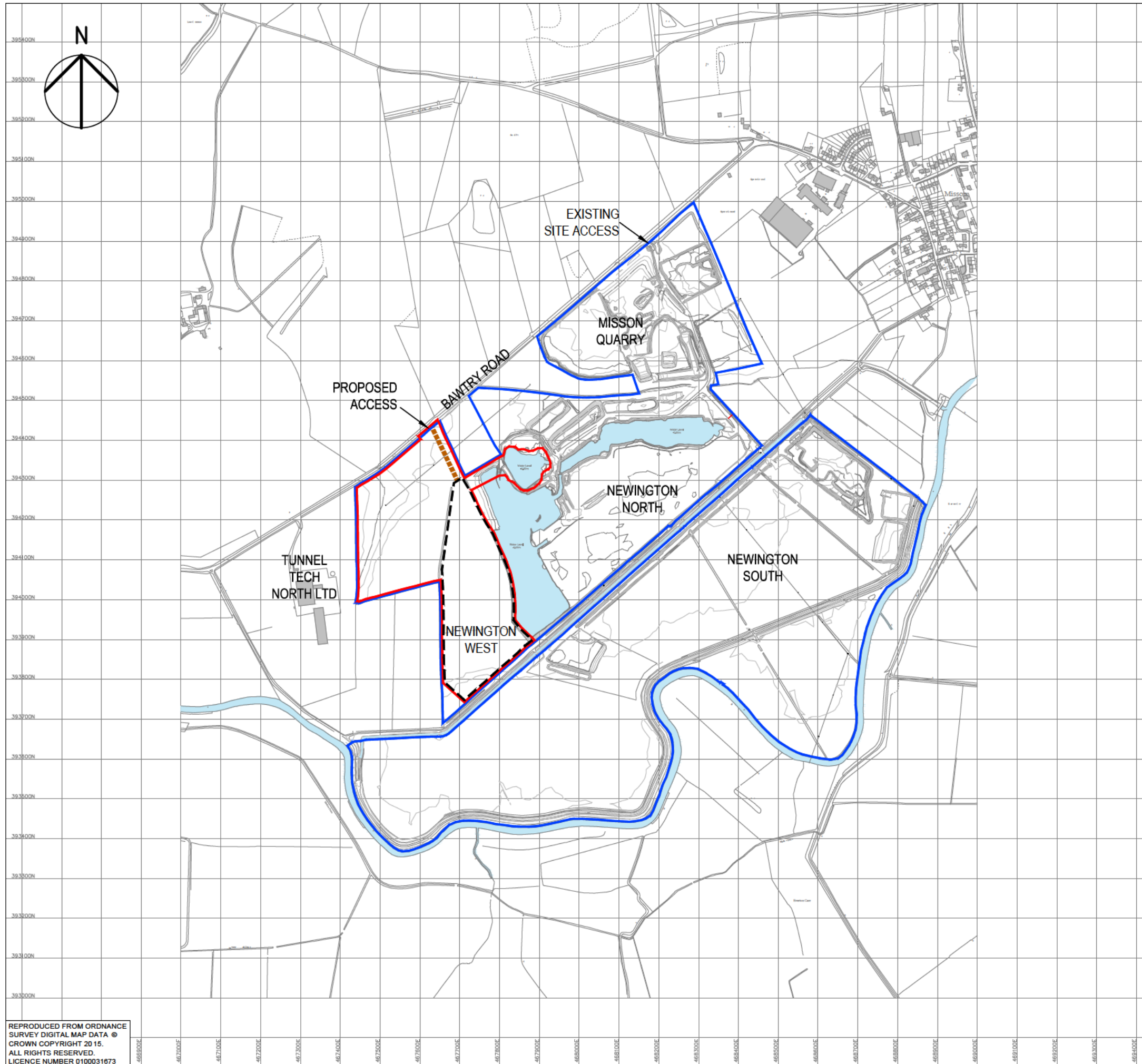

KEY

- LAND OWNERSHIP BOUNDARY
- PLANNING APPLICATION BOUNDARY
- MINERAL EXTRACTION LIMIT
- PROPOSED ACCESS ROUTE

NOTES

1. SEE DETAIL PLAN FOR PROPOSED ACCESS ARRANGEMENT

Purpose of issue

Project Title

NEWINGTON QUARRY

Drawing Title

PLANNING APPLICATION AREA

Designed	Drawn AAO	Checked IS	Approved CN	Date 02/15
----------	--------------	---------------	----------------	---------------

Scale @ A3 1: 10,000	URS Internal Project No. 47072089
-------------------------	--------------------------------------

THIS DOCUMENT HAS BEEN PREPARED PURSUANT TO AND SUBJECT TO THE TERMS OF URS' APPOINTMENT BY ITS CLIENT. URS ACCEPTS NO LIABILITY FOR ANY USE OF THIS DOCUMENT OTHER THAN BY ITS ORIGINAL CLIENT OR FOLLOWING URS' EXPRESS AGREEMENT TO SUCH USE, AND ONLY FOR THE PURPOSES FOR WHICH IT WAS PREPARED AND PROVIDED.

Client



AECOM

Royal Court, Basil Close
Chesterfield
Derbyshire. S41 7SL
Telephone: (01246) 209221
Fax: (01246) 209229
www.aecom.com



Drawing Number

47072089.NW.SS.003

Rev

Barnby Moor Quarry – Information Sheet

1. Location

- 1.1. Proposed boundary of the site – See Drawing BM II.02 Site Area Plan
- 1.2. The extent of excavations – See Drawing BM II.03 Extraction Boundary and Phasing
- 1.3. Proposed access to the site, including a map of key routes from the site to the nearest major roads
See Drawing BM II.03 Extraction Boundary and Phasing
- 1.4. Possible location(s) of processing plant – None proposed
- 1.5. Phasing – See Drawing BM II.03 Extraction Boundary and Phasing
- 1.6. An OS map of the site – See Drawing BM II.01 Site Location
- 1.7. Estimated number of HGV movements per day/month/year 75 movements per day

2. Reserve Data (with supporting evidence)

- 2.1. Quality and quantity of recoverable reserves – Approximately 0.45 million tonnes. The Site is underlain entirely by the Chester Formation, the upper unit of the Sherwood Sandstone Group. It comprises a pinkish red or buff-grey, medium to coarse-grained, pebbly sandstone. Below the Sherwood Sandstone is the Roxby Formation, comprised of mudstone and siltstone. The area was prospected by drilling, sampling and testing in the 1990s with a good quality resource identified. Geological and borehole logs indicate the sand and gravel resource underlying the Site is approximately 3m thick.
- 2.2. estimated output per annum Approximately 150,000tpa
- 2.3. estimated lifespan of the mineral working (years) Approximately 3 years
- 2.4. When will the site be ready to be worked? 2019

3. Role of site/markets

- 3.1. Is the site a new Greenfield site or an extension? New Greenfield site
- 3.2. If a Greenfield site, is it replacing an existing mineral working within or outside the county – Replacement site for Hanson's Newington Quarry
- 3.3. What is your planned market area? Predominantly Nottinghamshire and South Yorkshire
- 3.4. Is the location of the site optimum in terms of serving the market? Yes

4. Availability of Mineral

- 4.1. Do you have the legal rights to work all of the mineral including access to a public highway or any other transport route? Hanson QPE is in the process of negotiating a lease agreement from land owners.

5. Landowner Consent

- 5.1. Who is the legal owner of the site? Grange Farm (Barnby Moor) Ltd
- 5.2. Is the legal owner of the site also a minerals operator? No
- 5.3. Has the legal owner made a formal agreement with any mineral operator for minerals exploration and/or minerals extraction – Hanson QPE is in the process of negotiating a lease agreement from land owners.

6. Agricultural land quality

- 6.1. Agricultural land classifications found within the site – subgrades 3a and 3b soils.

7. Sensitive Receptors

- 7.1. Is the site located within 250m of any sensitive receptors? (schools, residential dwellings, workplaces, healthcare facilities) Yes, residential dwellings.

8. Reclamation

8.1. Proposed reclamation schemes – what opportunities for environmental benefits do you see arising from the scheme? **See Drawing 08 Restoration Masterplan. The restoration scheme will be a combination of agriculture and biodiversity, providing agricultural land, with field boundaries (hedgerows) either retained or newly created and also biodiversity habitat, including shallow waterbodies, ponds and scrapes; reedbeds; wet grassland; and blocks of scrub planting.**

8.2. Does the reclamation of the site depend on importing fill? If so, please indicate type of waste, main sources and timescales – **Silt from the washing process to be returned for progressive restoration as the site is worked.**



KEY

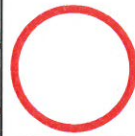

SITE LOCATION

Plot Date : 13 September 2018 11:38:09
 File Name : \\CH-MIP-001\WP2\CH_SHARE\2\CH_WASTE_MANAGEMENT\60582207 HANSON BARNBY MOOR IIM. TECHNICAL\DRAWINGS\PLANS IIBM II.01 SITE LOCATION

REPRODUCED FROM ORDNANCE
 SURVEY DIGITAL MAP DATA ©
 CROWN COPYRIGHT 2017.
 ALL RIGHTS RESERVED.
 LICENCE NUMBER 0100031673

Drawing Title

**BARNBY MOOR QUARRY
SITE LOCATION**

Purpose of issue		
Drawn AAO	Checked IS	Approved CN
Date 08/18	Scale @ A4 1:50,000	Rev -
Drawing Number BM II.01		

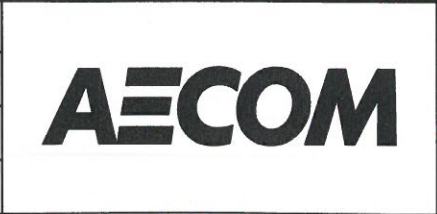

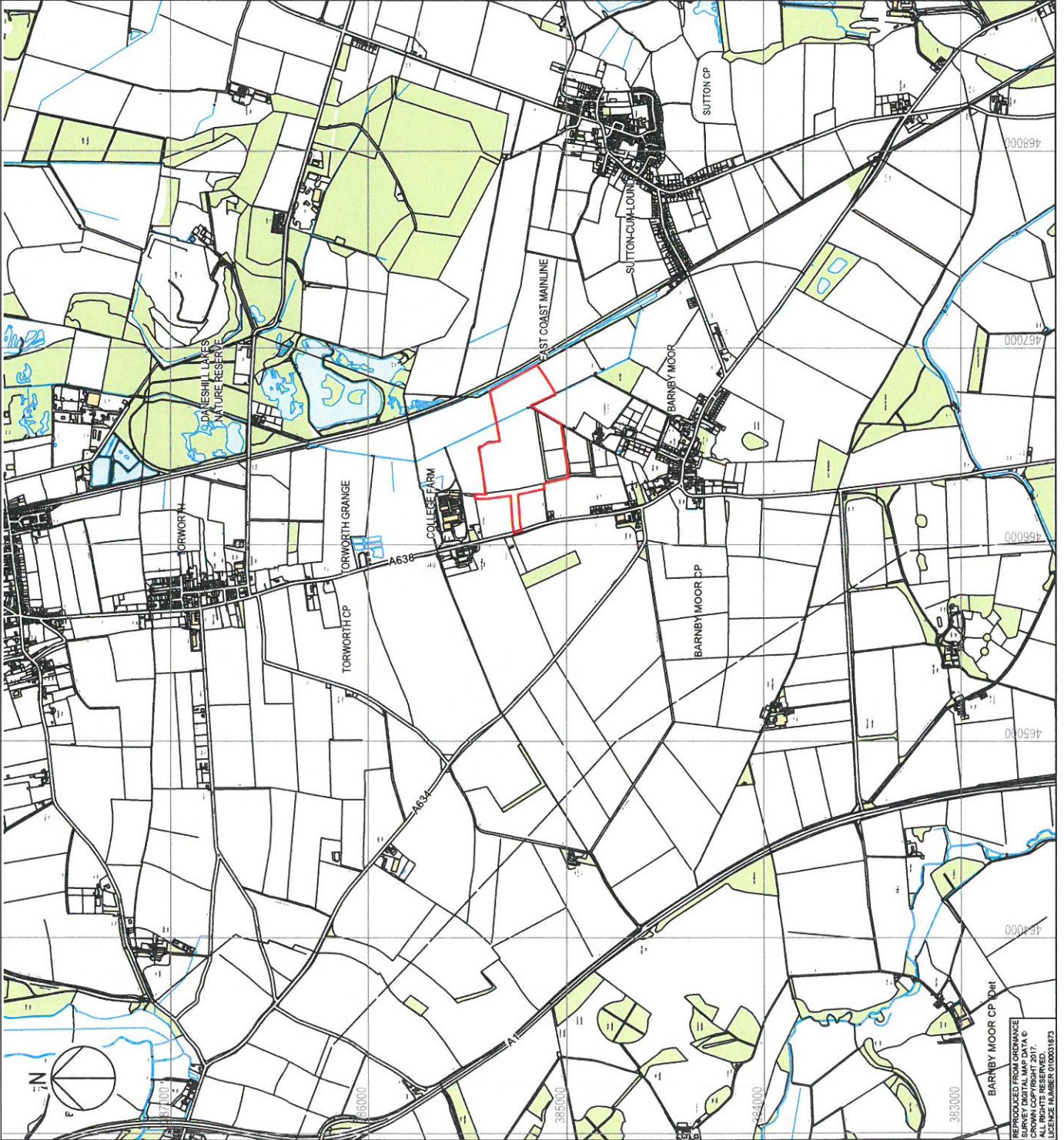

KEY

— SITE BOUNDARY

Purpose of Issue

Project Title

BARNBY MOOR QUARRY

Drawing Title

SITE AREA PLAN

Designed	Drawn	Checked	Approved	Date
	AAO	CN	CN	08/18

Scale @ A3
1:20,000
AECOM Internal Project No.
60582207

THIS DOCUMENT HAS BEEN PREPARED PURSUANT TO AND SUBJECT TO THE TERMS OF AECOM APPOINTMENT BY ITS CLIENT. AECOM ACCEPTS NO LIABILITY FOR ANY USE OF THIS DOCUMENT OTHER THAN BY ITS ORIGINAL CLIENT OR FOLLOWING AECOM EXPRESS AGREEMENT TO SUCH USE, AND ONLY FOR THE PURPOSES FOR WHICH IT WAS PREPARED AND PROVIDED.

Client



AECOM
Royal Court, Basil Close
Chislehurst
Dorset, BA1 7SL
Telephone: (01248) 208221
Fax: (01248) 208229
www.aecom.com

AECOM

Drawing Number

BM II.02

Rev

-

KEY SITE BOUNDARY LAND WITHIN THE CONTROL OF THE APPLICANT MINERAL EXTRACTION BOUNDARY	Purpose of Issue Project Title <h2 style="text-align: center;">BARNBY MOOR QUARRY</h2> <h3 style="text-align: center;">EXTRACTION BOUNDARY AND PHASING</h3>	<table border="1" style="width: 100%; border-collapse: collapse;"> <tr> <td>Designed</td> <td>Drawn</td> <td>Checked</td> <td>Approved</td> <td>Date</td> </tr> <tr> <td></td> <td>AAO</td> <td>JS</td> <td>CN</td> <td>08/18</td> </tr> </table>	Designed	Drawn	Checked	Approved	Date		AAO	JS	CN	08/18	Scale @ A3 1: 5,000 AECOM Internal Project No. 60582207	<p style="font-size: small;">THIS DOCUMENT HAS BEEN PREPARED PURSUANT TO AND SUBJECT TO THE TERMS OF AECOM APPOINTMENT BY ITS CLIENT. AECOM ACCEPTS NO LIABILITY FOR ANY USE OF THIS DOCUMENT OTHER THAN BY ITS ORIGINAL CLIENT OR FOLLOWING AECOM EXPRESS AGREEMENT TO SUCH USE, AND ONLY FOR THE PURPOSES FOR WHICH IT WAS PREPARED AND PROVIDED.</p> <div style="text-align: center;"> <p>Hanson HEIDELBERGCEMENT Group</p> </div> <p style="font-size: x-small;"> AECOM Royal Court, Basil Close Chesterfield Derbyshire, S41 7SL Telephone: (01246) 209221 Fax: (01246) 209229 www.aecom.com </p>
Designed	Drawn	Checked	Approved	Date										
	AAO	JS	CN	08/18										
				Drawing Number <h1 style="margin: 0;">BM II.03</h1>										

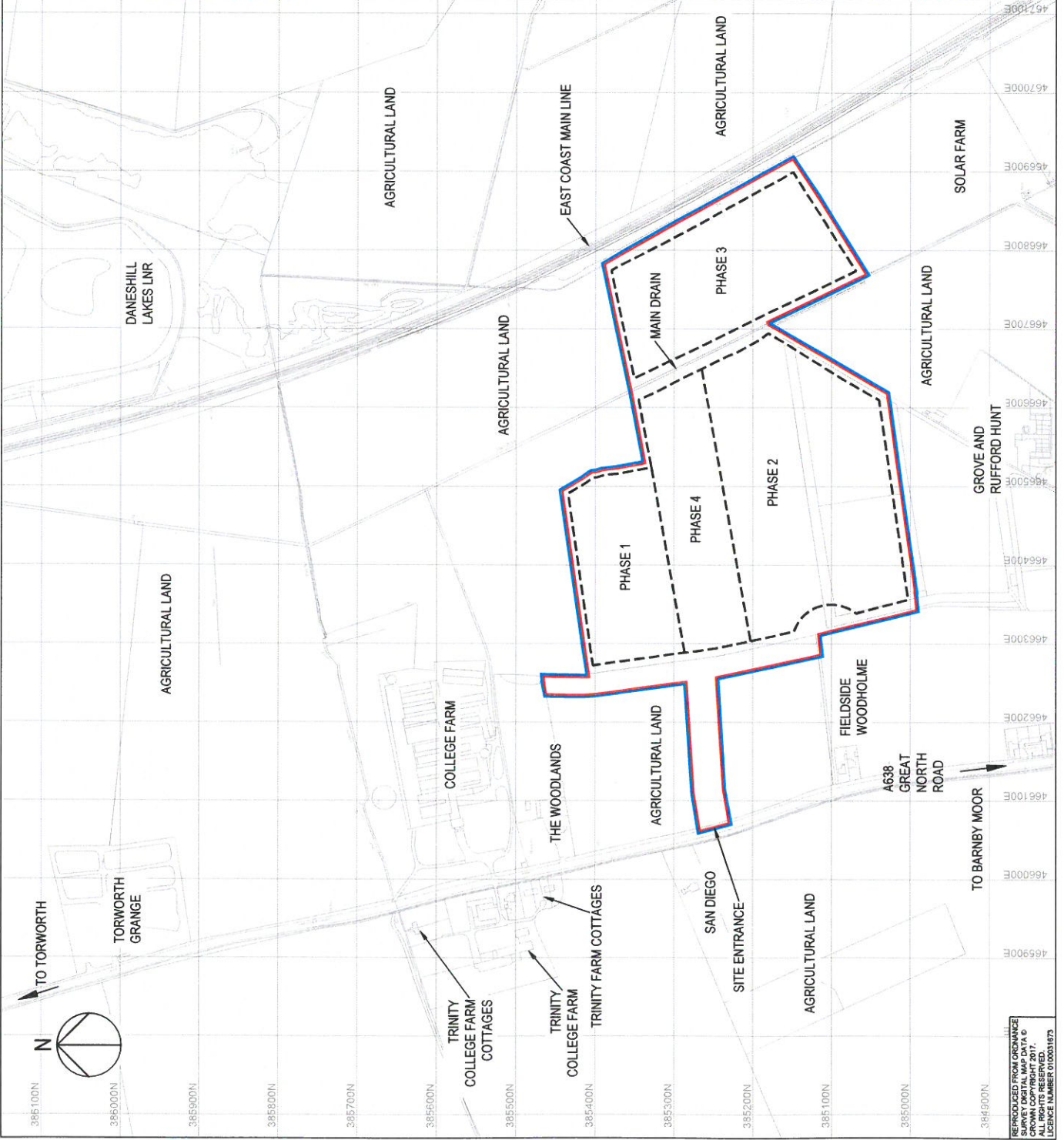

REPRODUCED FROM ORDINANCE
 SURVEY DIGITAL MAP DATA ©
 THE NATIONAL GRID. ALL RIGHTS RESERVED.
 LICENCE NUMBER 0100031873

LEGEND

- Site boundary
- Wet grassland
- Agriculture
- Waterbodies, ponds and scrapes
- Reedbeds
- Proposed hedgerow
- Existing hedgerow
- Limit of mineral extraction
- Existing Main Drain
- Main Drain crossing point
- Sluice/ outfall control point
- Existing woodland
- Proposed woodland
- Contours @ 0.5m
- Field gate
- Section location (Refer to Drawing No. 09)

Note:
1. Restoration achieved using imported silt soils.

Client



Project: Barnby Moor Quarry

Title: Restoration Masterplan

Scale	1:4,000	Date	17.08.18	Checked by	CD	Reviewed by	JW
Drawing No							

08



Drawn (UK) Ltd
Moorbeck Hall
Leeds
LS15 4TA
t: 0113 275 9977
e: info@drawuk.com
www.draw-uk.com

